

RACKIT™

BILLET ALUMINUM CARGO RACKS



Manufactured by:
Pro Moto Billet
11461 Lonestar Rd
Nampa ID 83651
208-466-4762

Thank you for purchasing the best looking rack in the motorcycle industry. Your new rack is constructed of 6061-billet aluminum and then anodized to give you a high quality and good-looking rack for years of backpack free riding enjoyment.

Instructions: Honda 04-05 CRF250R*04-09 CRF250X (PMB-01-1201)

1. We recommend using a removable thread-locking agent on all bolts.
2. Remove the 2 seat bolts. Remove the left and right side panels.
3. Remove the rear fender mounting bolts and the fender nuts (under fender, **FIGURE 1**).
4. Remove the rear exhaust mounting bolt.
5. Drill out the 6 mm threads in the left and right rear fender nuts with a 1/4" drill bit. **FIGURE 2**
6. Re-install the left and right rear fender mounting nuts that now have the threads removed.
7. Loosely install the left and right side arm supports using two 6x30mm hex head bolts, install these bolts into the rear fender washers, through the two 8x16x4 spacers and into the treaded rack side arm support. These rear fender mounting bolts are now accessed from under the fender. **FIGURE 1**
8. Re-install the rear exhaust bolt, placing the 6x16x4 spacer between the exhaust pipe mount and subframe. Tighten this bolt now. **FIGURE 3**
9. Using the provided template as a guide, trim the inside of the left side panel. **FIGURE 4** This needs to be trimmed to provide proper clearance for the rack side arm support. Use a sharp utility razor knife and trim small amounts at a time to ensure the best results.
10. Re-install the plastic side panels, you must slip the rear edge of the panels under the upper portion of the rack side arm supports, then tuck them into place. Install and tighten the lower front side panel bolts.
11. Make sure the stock side panel washers are in place at the seat mounting locations. Use the 8x20x6 fender washers if stock washers are not separate from the bolts.
12. Install the two 8x16x11 spacers between the rack side arm supports and the seat mounting bolt locations, and then loosely install the two 8Xx35 mm socket head bolts.
13. Install the rack top to the rack side support using four 6x16 mm flat head bolts. Tighten all four bolts.
14. Tighten the seat mounting bolts, then the under fender bolts.
15. Tighten all bolts on the rack assembly. Periodically check bolts for tightness.
16. CRF 250 R models, when removing the seat to clean the air filter, loosen the two under fender bolts before removing the seat bolts. This will allow the seat bolts to come out easier.

Caution: As with all racks on dirt bikes, they should not have excess amounts of weight put on them. Excess weight can damage the rear subframe of the motorcycle.

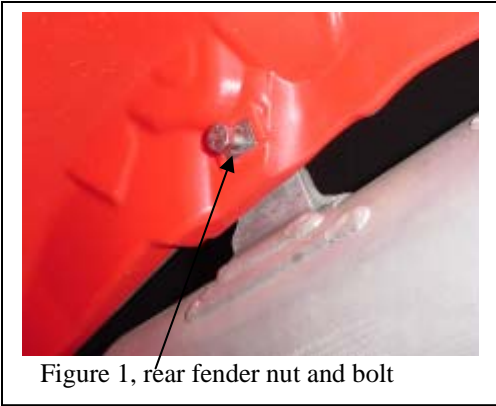

Figure 1, rear fender nut and bolt



Figure 2, drill rear fender nuts

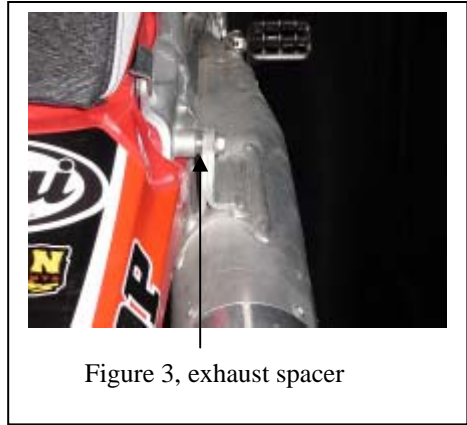

Figure 3, exhaust spacer

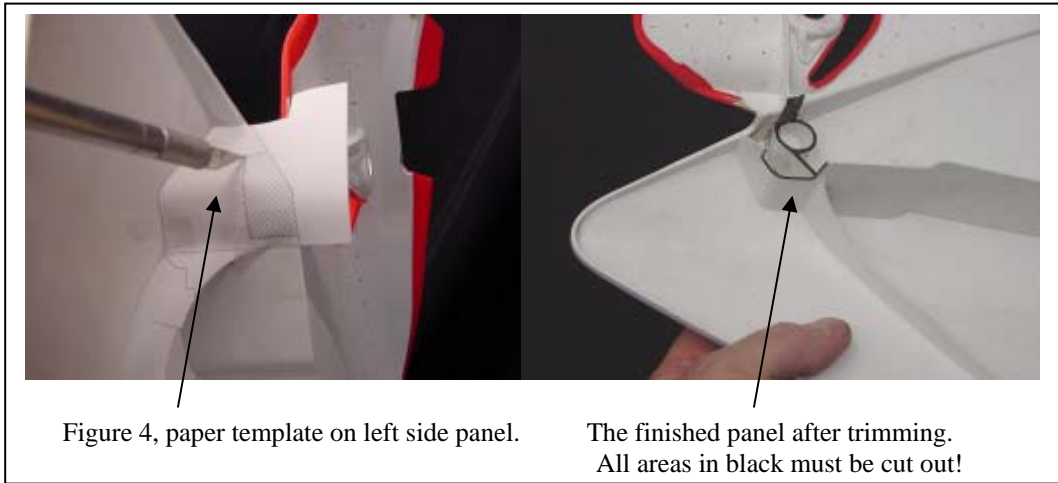

Figure 4, paper template on left side panel.

The finished panel after trimming.
All areas in black must be cut out!

- Parts List:**
- 1-Top
 - 2-Arms
 - 1- 6x16x4 Spacer
 - 2-8x16x4 Spacer
 - 2-8x16x11 Spacer
 - 2-6x30 HH
 - 2-8x35 SH
 - 4-6x16 FH
 - 2-8x20x6 Fender Washers

