

NOTE: We recommend using a thread-locking agent on all bolt threads.

Before you begin: Read the main instructions carefully before starting the installation. Visit www.youtube.com/promotobillet to watch the installation video for this Cargo Rack and other Fastway products.

To install your new rack:

1. This installation requires cutting the fender and air box/number plate. If you do not feel that you can safely cut the required plastic parts, have your dealer install the rack for you. Cut templates (**see Pg. 2**) are included as a reference but additional trimming may be required to achieve a perfect fit.
2. Here are a few techniques that can be used to make the necessary cuts:
 - a. Heat a utility knife with a heat gun or propane torch and cut the plastic with the hot knife.
 - b. Drill a hole or a series of holes in the plastic and then use a knife to trim out the remaining material.
 - c. Use a rotary tool with a high-speed cutting insert.
3. Remove the seat by removing the bolt above the rear fender.
4. Remove the air box covers on the left and right side and rear fender.
5. Remove the bolts that secure the muffler (keep nord lock washers), Remove the air box. **Figure 1.**
6. Cut air box using Templates A, B, and C. then install the air box and rear fender. **Figures 2, 3, 4, 5.**
7. Install "Right Side Arm" (Item2) into the inside of the subframe (through template cuts B and C) onto the back side of the muffler mounts. Using the "nord lock" washers (mentioned in step 5) with the M6 X 45 bolts (Item 11) to mount the exhaust with 8mm .040 shims (Item 15) between the muffler and subframe. Add the M6 flat washer (Item 10) and the M6 Nylock nut (Item 8) to the end of the M6 X 40 bolt (Item 11) to tightly secure the right-side arm. **Figures 6 and 7.**
8. Install "Bulk Head" (Item 6) and "Mini Clamps" (Item 7) on left side of sub frame. Install the mini clamps and bolts, then slide the "bulk head" up as high as you can and then back down 1 1/4th inch and tighten bolts. **Figure 8.**
9. Install the "Left-Side Arm" (item 5) (through template cut A) into the "bulk head" using the M6 X 20 bolts and M6 washers (Items 10/13)
10. Loosely install the Left-Side Arm" (Item 4) using the M6 X 20 (Items 10/13) bolts and M6 washer. **Figure 9.**
11. Install the "Right-Side Arm" (Item 1) using the M6 X 14 (Items 10/13) bolts and M6 washer. **Figure 10.**
12. Using the M6 X 16 (Item 14) to install the "Top Rack" (Item 3) and then tighten all the bolts. If the rack does not line up to the end of the rear fender, loosen the "bulk head" and slightly adjust it up or down to get the rack lined up with the rear fender.
13. Tighten all fasteners and reinstall all plastics. **Figure 11.**

**** TEMPLATE NEEDS TO BE PRINTED “**ACTUAL SIZE**” OR SIZE WILL NOT BE CORRECT****

The width of each box needs to be 3.1 inches.

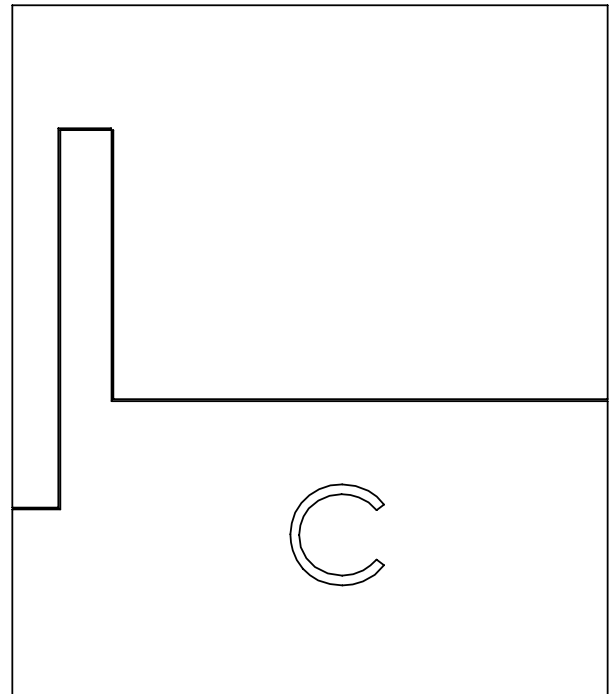
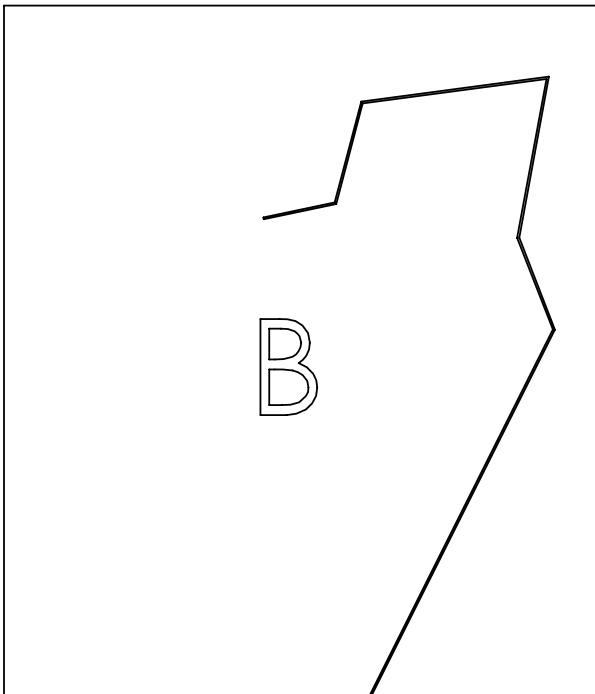
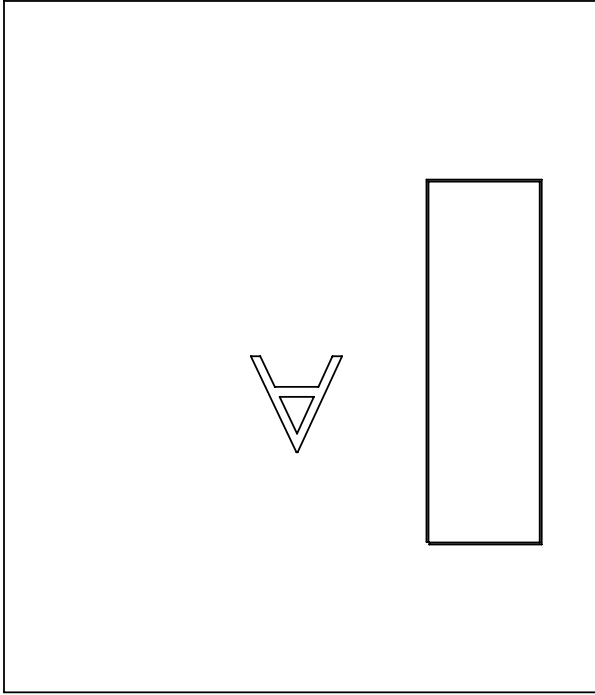

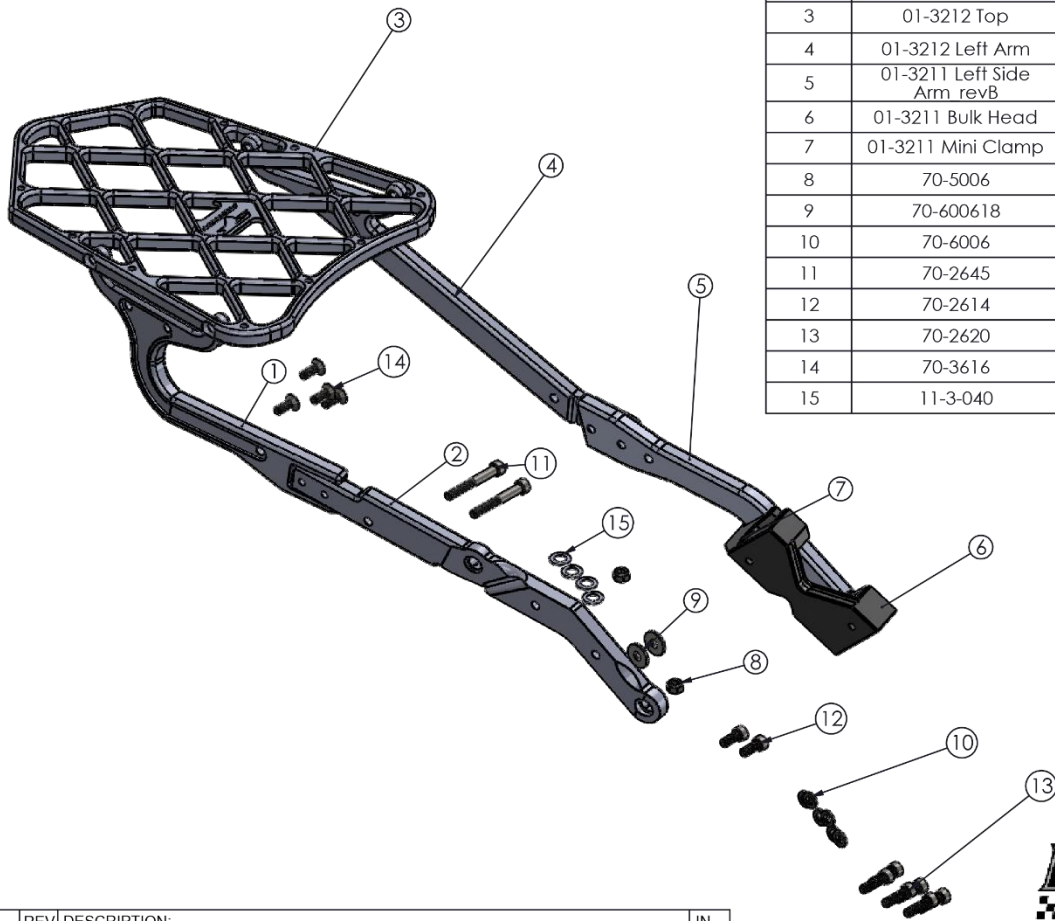

BOM Table			
ITEM NO.	PART NUMBER	DESCRIPTION	QTY.
1	01-3212 Right Arm		1
2	01-3212 Right Arm Lower		1
3	01-3212 Top		1
4	01-3212 Left Arm		1
5	01-3211 Left Side Arm revB		1
6	01-3211 Bulk Head		1
7	01-3211 Mini Clamp		2
8	70-5006	NUT M6 NYLOCK S/S	2
9	70-600618		2
10	70-6006	WASHER M6 FLAT S/S	8
11	70-2645	BOLT M6X45 SOCKET S/S	2
12	70-2614	BOLT M6X14 SOCKET S/S	2
13	70-2620	BOLT M6X20 SOCKET S/S	6
14	70-3616	BOLT M6X16 FLAT S/S	4
15	11-3-040	FOOTPEG SHIM .040"	4

DATE	REV	DESCRIPTION:	IN.
11/13/19	A	Initial Release	JW
-	-	-	-
-	-	-	-

APPROVED BY :	SHEET : 1 / 1	DATE : 8/26/19
SCALE : 1:4	DRAWN BY : Jason Wilke	PART NAME : Cargo Rack
FORMAT : A	PART NUMBER : PMB-01-3212	

Figure 1.



Figure 2

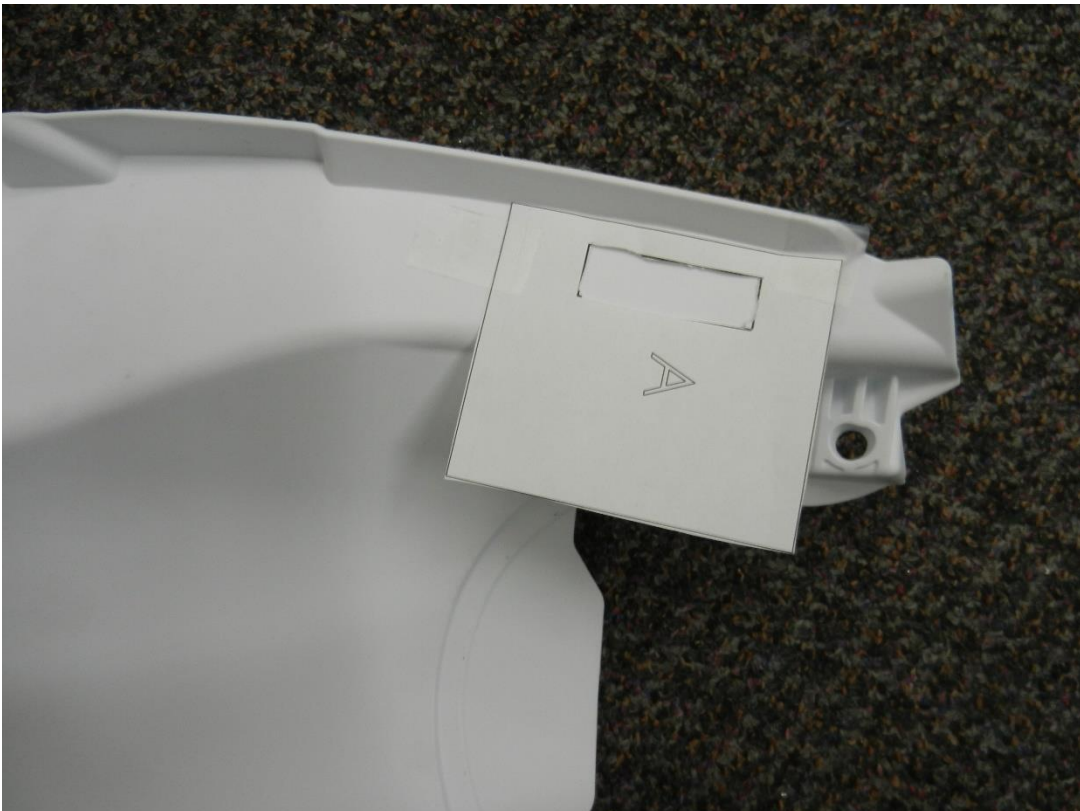

Figure 3

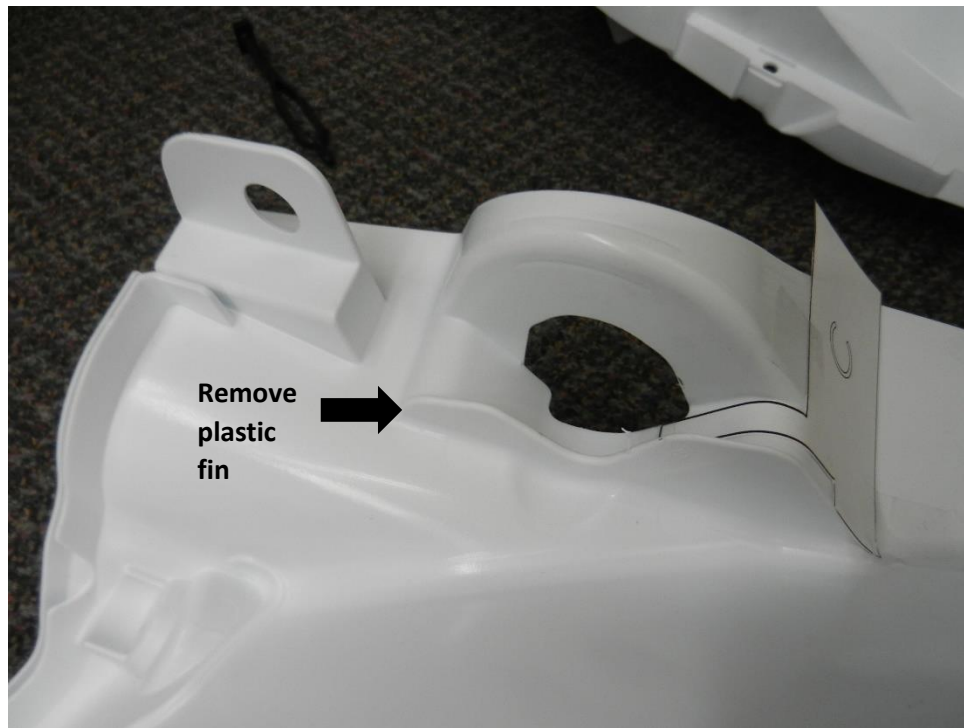

Figure 4



Figure 5

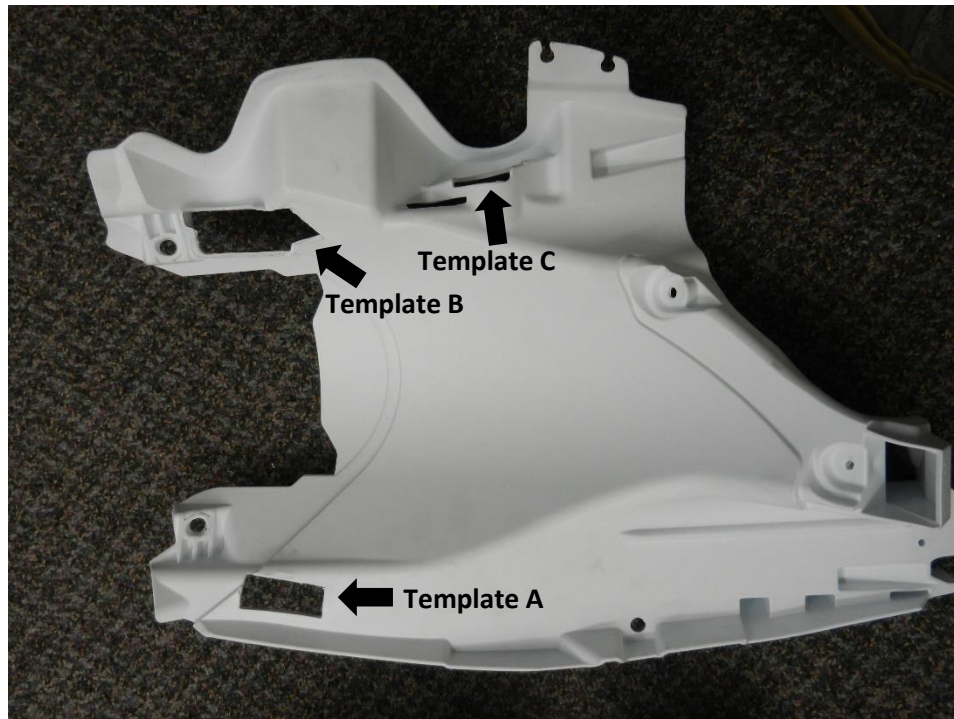

Figure 6



Figure 7



Figure 8



Figure 9



Figure 10



Figure 11



Figure 12

