

# Yamaha YFZ 450 Stabilizer Mounting Instruction ASV-LM-0807

1. A small amount of semi-permanent thread locking fluid (Blue Loctite #243 or equivalent) should be applied to all fasteners included with stabilizer kit. After a short first ride, check that all bolts are still tight.
2. Install both heim joints (Items# 8 and 9) into the Damper Arm Link (Item# 13) making sure to include the Jam Nuts (Items# 14 and 15). The side of the damper arm link with the groove has left handed threads. Be sure both heim joints have an equal amount of threads showing. (Picture A)
3. Install the Damper Arm Link (Item# 13) onto the Steering Stem Clamp using one 35mm long M8 bolt (Item# 12), link arm spacer (Item# 6), 8mm washer (Item# 10), and two heim joint covers (Item# 7). (Picture B)
4. Install Steering Stem Clamp on steering stem as shown using the associated four bolts and set screw. (Pictures C and D)

*Helpful Tip: Spin backwards, install bolts lightly, then spin clamp 180° into position. The goal is to get the vehicle's wheels pointing straight with the steering stem clamp perpendicular to front wheels.*

5. Bolt the Damper Mounting Spacer (Item# 3) to the Upper Mounting Plate (Item# 1) using two 25mm long M8 bolts (Item# 17). (Picture E)
6. Place the damper mounting spacer and upper mounting plate onto frame rails as shown. The notches in the upper mounting plate fit over the front frame rails. The front hole underneath the mounting bracket should be aligned with the hole in the frame's gusset. (Picture F)
7. Bolt the upper mounting plate and damper mounting spacer to the frame, using the M8 hex head bolt. (Picture G)
8. Loosely install the Lower Mounting Plate and bolt to Upper Mounting Plate using two 30mm M8

| ITEM NO. | PART NUMBER             | DESCRIPTION                                 | QTY. |
|----------|-------------------------|---|------|
| 1        | LK-PL014_revB           | Upper Mounting Plate/ YFZ&Raptor            | 1    |
| 2        | LK-PL017_revB           | Lower Mounting Plate/ YFZ&Raptor            | 1    |
| 3        | LK-PL015_revC           | Damper Mounting Spacer                      | 1    |
| 4        | 70-2830                 | BOLT M8X30 SOCKET S/S                       | 2    |
| 5        | VJ1-8.8-M8-1.25-20-WHZ  | M8 Hex Head Bolt, Truncated base with teeth | 1    |
| 6        | LK-SP062_revB           | Link Arm Spacer                             | 2    |
| 7        | LK-MS150                | Heim Joint Cover                            | 4    |
| 8        | POS8                    | M8x1.5 Heim Joint                           | 1    |
| 9        | POS8L                   | M8x1.25 Left Hand Heim Joint                | 1    |
| 10       | 70-6008                 | Washer M8 Flat S/S                          | 2    |
| 11       | VB1-12,9-M8-1,25-30-BLZ | BOLT M8x30 SOCKET                           | 1    |
| 12       | VB1-12,9-M8-1,25-35-BLZ | M8 bolt, 35mm long (1-3/8")                 | 1    |
| 13       | LK-TG037_revD           | Damper Arm Link 75mm                        | 1    |
| 14       | EB6-70-M8x1,25-5,0      | M8x1.25 Jam Nut                             | 1    |
| 15       | EB6-70-M8x1,25-5,0 LH   | M8x1.25 Left Hand Jam Nut                   | 1    |
| 16       | VC1-10,9-M5-0,8-25-BLZ  | M5 bolt, 25mm long (1")                     | 1    |
| 17       | 70-2825                 | BOLT M8x25 SOCKET S/S                       | 2    |
| 18       | LK-PL010_revF           | Control Arm ATV                             | 1    |

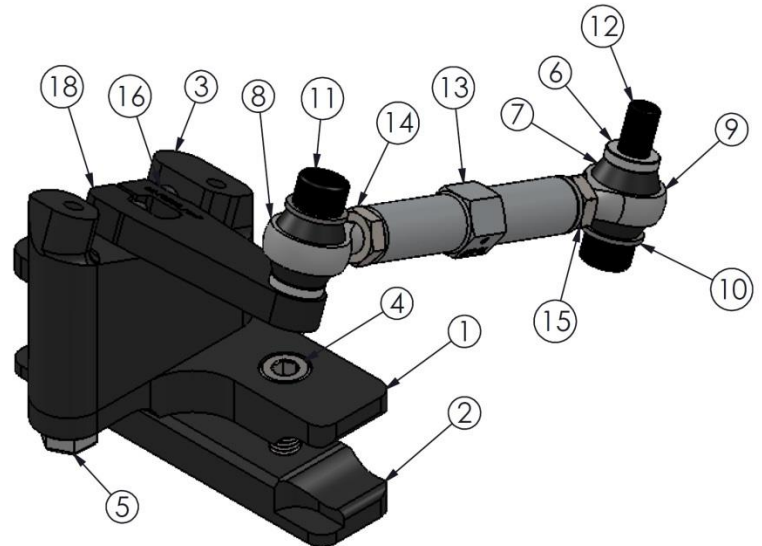

bolts (Item# 4). Adjust as necessary and check that the plate clears any frame welds.

9. Install Transfer Arm (Item# 18) onto Steering Stabilizer using the M5 bolt (Item# 16). (Pictures J and K)
10. Install Stabilizer onto Damper Mounting Spacer using two 16mm long M6 bolts. (Provided with your steering damper)
11. Install the Damper Arm Link to the Transfer Arm with a spacer in between using one 30mm long M8 bolt (Item# 11), an M8 washer (Item# 10), and two dust covers (Item# 7).
12. Center and tighten the Steering Stem Clamp and set screw. Verify that the steering stem, damper arm link, and transfer arm are all set perpendicular to each other when the front wheels are pointed straight. (Picture L)
13. Once the transfer arm, damper arm link, and steering stem clamp have been set perpendicular to each other, tighten both jam nuts.
14. Check all bolts; ensure steering travel hasn't been compromised. Make sure all components clear brake lines, radiator hoses, and other stock parts.

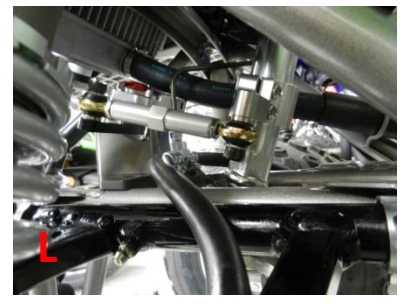
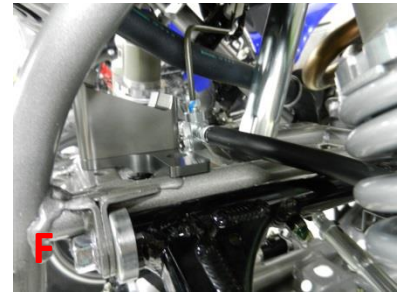

**Thanks for purchasing a Fastway Steering Stabilizer. If you have any questions feel free to give us a call toll free at 866-466-4762 or e-mail [sales@promotobillet.com](mailto:sales@promotobillet.com)**