

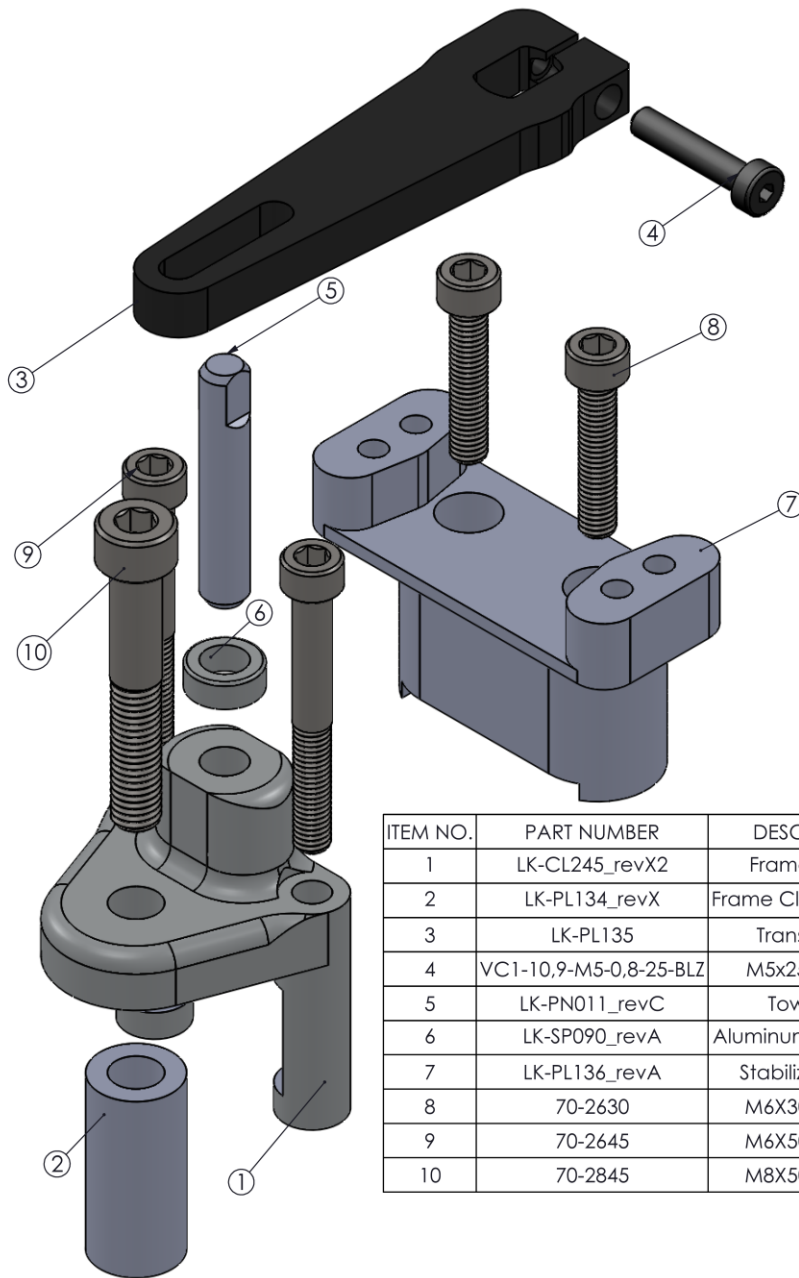

# Stabilizer Mount Installation (ASS-MC-0104)



ITEM NO.	PART NUMBER	DESCRIPTION	QTY.
1	LK-CL245_revX2	Frame Clamp	1
2	LK-PL134_revX	Frame Clamp Spacer	1
3	LK-PL135	Transfer Arm	1
4	VC1-10,9-M5-0,8-25-BLZ	M5x25mm Bolt	1
5	LK-PN011_revC	Tower Pin	1
6	LK-SP090_revA	Aluminum Pin Spacer	1
7	LK-PL136_revA	Stabilizer Mount	1
8	70-2630	M6X30mm Bolt	2
9	70-2645	M6X50mm Bolt	2
10	70-2845	M8X50mm Bolt	1

1. Ensure that the bike is secure to prevent it from falling over during the installation.
2. **A small amount of semi-permanent thread locking fluid (Blue Loctite #243 or equivalent) should be applied to all fasteners included with stabilizer kit. After a short first ride, check that all bolts are still tight.**
3. Slide the transfer arm (Item 3) onto the stabilizer. The arm should fit snugly onto the stabilizer. **DO NOT** hammer the arm onto the stabilizer. If necessary, rock the arm back and forth into place. Secure the transfer arm to the stabilizer using the M5 bolt (Item 4).
4. Remove the four plastic plugs on the triple clamp and frame (two each).
5. Remove front fuel tank bolt and sleeve.
6. Insert the frame clamp spacer (Item 2) into the rubber fuel tank grommet. (Figure 1)
7. Slide the frame clamp (Item 1) back over fuel tank tab.
8. Secure the frame clamp using two M6x50mm (Item 9) and one M8x50mm (Item 10) bolts. Ensure that frame clamp spacer is positioned in the recess on frame clamp when tightening bolts. (Figure 2)



Figure 1



Figure 2

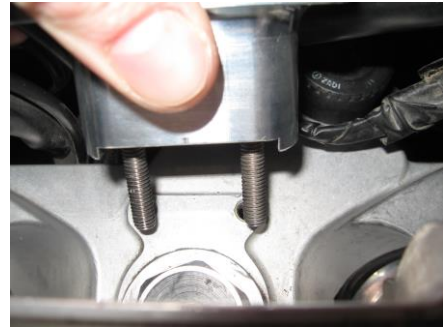

Figure 3

9. Using two M6x30mm (Item 8) bolts attach stabilizer mount (Item 7) to triple clamp. (Figure 3) The stabilizer mount is reversible to allow for both positions of the stock handlebar clamps. Use the holes closest to the handlebars to attach the stabilizer to the mount. It may be necessary to remove the stabilizer mount and reverse it to achieve proper fit.
10. Apply a light coat of grease to the tower pin (Item 5) and slide it into the frame clamp. Grease should also be applied to the flat section on the top of tower pin where it inserts into the transfer arm.  
**The aluminum spacer (Item 6) on the tower pin is adjustable!** Gently tap on the top of the pin with a hammer to adjust height. The top of the tower pin should be flush with the top of the transfer arm. (Figures 4 & 5)
11. Install stabilizer onto mount using hardware included with the stabilizer.



Figure 4



Figure 5



**Thanks for purchasing a  
Fastway steering stabilizer.  
If you have any questions  
feel free to give us a call  
toll free at 866-466-4762 or  
e-mail  
[sales@promotobillet.com](mailto:sales@promotobillet.com)**